

cookworks

Filter Coffee Maker With Timer

Model No. CM2021T



Care & Instruction Manual

For household and indoor use only

Please read these instructions before use and retain for future reference



Electrical safety

- You should only plug the appliance into a 220V-240V AC, 50Hz supply. Connecting it to other power sources may damage the appliance and will invalidate the guarantee.
- Switch off and unplug when not in use and before cleaning the appliance.
- Keep the appliance and its cord out of reach of children less than 8 years.
- Do not allow children to use the appliance without supervision.
- This appliance can be used by children aged from 8 years and above and persons with reduced physical, sensory or mental capabilities or lack of experience and knowledge if they have been given supervision or instruction concerning use of the appliance in a safe way and understand the hazards involved. Children shall not play with the appliance. Cleaning and user maintenance shall not be made by children unless they are older than 8 and supervised.
- Keep cable, plug and outside of coffee maker dry and away from areas where it is likely to get splashed. Never immerse in water.
- Do not pull on the cable to disconnect from mains supply.
- Do not operate the appliance if damaged or after it malfunctions. In the event the supply cord is damaged, in order to avoid a hazard it must only be replaced by a qualified service engineer, with a suitably approved part.
- This appliance must be positioned so that the plug is accessible and the plug socket is within easy reach of the power cord.
- This appliance must be plugged in to an earthed socket outlet.

Warning!

- This appliance is intended exclusively for use in domestic households. It is not suitable for commercial use.
- Do not cover and allow to the coffee maker to cool fully before storing.
- The surfaces of the coffee maker will become hot during use. Do not touch and always carry the jug by the handle. Note the hotplate surface will retain residual heat after use.
- Do not use the coffee maker near or under surfaces that are heat sensitive or those that may be damaged by steam.
- Always close the lid before use and ideally, allow the coffee maker to complete the brewing process before removing the glass jug.
- Use only with the parts provided and to heat water. This appliance can cause personal injury if misused.
- This coffee maker is fitted with a safety device that automatically switches off the heater element if the appliance is inadvertently switched on when empty, or if it boils dry. In this case allow the coffee maker to cool completely (minimum 5 minutes) before refilling with cold water. The coffee maker will resume operation after refilling.
- This coffee maker is fitted with an anti-drip valve. This means that the glass jug may be removed from the hotplate for a short while (e.g. to pour a cup of coffee) whilst the coffee maker is in operation. Always replace the jug on the hotplate immediately after pouring. Failure to replace the glass jug promptly may lead to hot water and coffee overflowing from the filter holder.

Parts

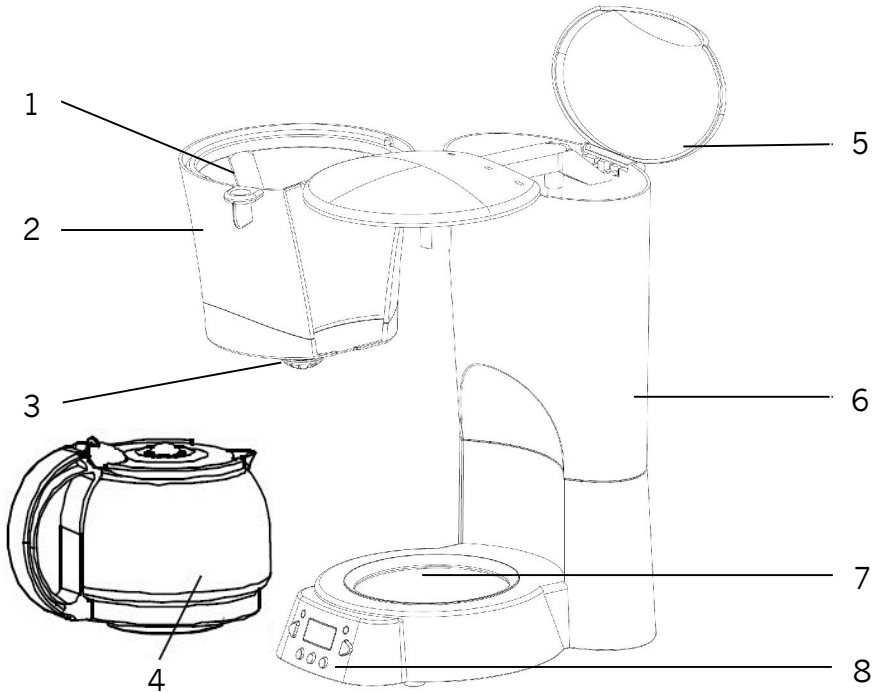

- | | | |
|--------------------|------------------------|------------------|
| 1. Mesh filter | 4. Glass jug with lid | 7. Hotplate |
| 2. Filter holder | 5. Water reservoir lid | 8. Control panel |
| 3. Anti drip valve | 6. Water reservoir | |

Control panel

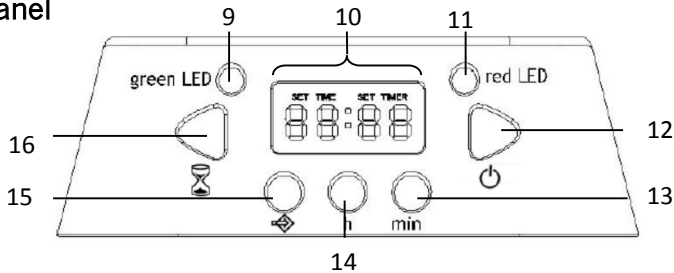

- | | |
|-----------------------|----------------------|
| 9. Timer indicator | 13. Minute button |
| 10. Display | 14. Hour button |
| 11. On indicator | 15. Set (◆) button |
| 12. ON/OFF (⏻) button | 16. Timer (⌚) button |

To use – Basic Operation

1. Place the coffee maker on a stable, flat, heat resistant surface and away from surfaces that may be damaged by steam.
2. Swing open the filter holder. Fit the mesh filter into the filter holder and add the **fresh ground coffee** for the required number of cups into the mesh filter according to personal taste. Close the filter holder and check that it is **fully engaged**.
3. Lift the reservoir lid and fill with water to the required level using the graduated markings on the reservoir as a guide. Do not fill past the maximum 10 cups (otherwise water will flow out of the overflow point onto the work surface) or fill below the minimum (3 cups) levels.
4. Close the reservoir lid and place the glass jug onto the hotplate.
5. Fully unwind the cable and plug in, the display will briefly illuminate and the time digits '12 00' will flash.
6. For safety do not allow the cable to dangle over the edge of units.
7. Press the ON/OFF (⏻) button, the red 'on' indicator will illuminate and the coffee maker will start to operate.
8. The coffee maker element will switch off automatically when all the coffee has been brewed but the 'on' indicator will remain lit for 40 minutes to indicate that the hotplate is still keeping the coffee warm.
9. Switch the coffee maker off using the ON/OFF button when the jug is empty and to avoid damaging the glass jug never replace the empty glass jug onto the warm hotplate.
10. To stop or interrupt the coffee making process, switch the appliance off using the ON/OFF (⏻) button or unplug from the mains.
11. After use, remove and empty the mesh filter (or remove paper filter, if used) and throw the waste grounds away.

Notes:

- Before using for the first time, fill the coffee maker to the maximum level with clean water, close the lid and allow the coffee maker to work. Do not use the mesh filter and discard the hot water after it is finished. Wash the loose parts (mesh filter, filter holder, glass jug and jug lid) in hot water with a little washing up liquid. Rinse and dry thoroughly. Not suitable for the dishwasher.

Notes (continued):



- For best results always use fresh cold water in the coffee maker and freshly ground beans. Serve coffee immediately after brewing.
- After 40 minutes the coffee maker will automatically enter standby mode and the coffee will no longer be kept warm.

Setting the clock

1. The clock is set in STANDBY MODE.
2. Plug in and switch on the coffee maker at the mains the display will briefly illuminate and the time digits '12 00' will flash.
3. Press the SET () button and 'SET TIME' will show in the display.
4. Press the HOUR (h) button until the correct hour is displayed.
5. Press the MIN button until the correct minute is displayed
6. The set time will save automatically a few seconds after the last press of a button and 'SET TIME' will disappear from the display.

Setting the timer (requires the clock to be set)

The coffee maker can be programmed to start to operate at a set time.

1. The timer is set in STANDBY MODE.
2. Plug in and switch on the coffee maker and set the time.
3. Press the SET () button TWICE and 'SET TIMER' will show in the display.
4. Press the HOUR (h) button until the correct hour is displayed.
5. Press the MIN button until the correct minute is displayed
6. The set time will save automatically a few seconds after the last press of a button and 'SET TIMER' will disappear from the display.
7. Press the TIMER () button, the green timer indicator will illuminate to show that the timer has been set.
8. Fill the coffee maker with water and ground coffee and fit the jug.
9. When the programmed start time is the same as the clock the red on indicator will illuminate, the coffee maker will start to operate and then switch off after the default 40 minutes.
10. To cancel the timer, press the TIMER () button and the timer indicator will extinguish.

Cleaning

To maximize the efficiency of the coffee maker, clean and descale regularly

1. Switch off and unplug the coffee maker and allow the coffee maker to cool completely.
2. Open the filter holder, remove and empty the mesh filter and place the glass jug onto the hotplate.
3. Descale with a proprietary descaler suitable for plastic coffee makers and use in accordance with the instructions on the pack. Alternatively half fill the coffee maker with water and add the juice of one lemon. Close the lid, switch on and allow the coffee maker to transfer some of the descaling solution before turning the coffee maker off and allowing it to stand for 15 minutes. Repeat this last step a further two times before discarding the solution.
4. After descaling, fill the coffee maker to the maximum level with clean water, close the reservoir lid and allow the coffee maker to work. Do not use a paper filter and discard the hot water after it is finished. Repeat this step a second time.
5. Wash loose parts (mesh filter, glass jug with lid) in hot water with a little washing up liquid. Rinse and dry thoroughly. Not suitable for the dishwasher.
6. Wipe external surfaces with a soft damp cloth and dry surfaces with a soft dry cloth. Do not use detergent or abrasives as these may scratch the surface. Never immerse in water.

Technical specification

Rated voltage	220-240V AC 50/60Hz
Power consumption	730 - 870W
Class rating	I (Earthed)
BS 1362 fuse	13A
Capacity	10 cups / 1.25 litre



Plug / Wiring advice

The wires in this mains lead are coloured in accordance with the following UK electrical code:

BLUE = NEUTRAL

BROWN = LIVE

GREEN + YELLOW = EARTH

Non-rewireable plug

This appliance may be fitted with a “non-rewireable” plug. If you need to change the fuse in a “non-rewireable” plug, the fuse cover must be refitted. If the fuse cover is lost or damaged, the appliance must not be used.

Rewireable plug

The colours of the wires in the mains lead of this appliance may not correspond with the coloured markings identifying the terminals in a rewireable plug. **Rewireable plugs should only be replaced by a suitably competent person. If in doubt, consult a qualified electrician.**

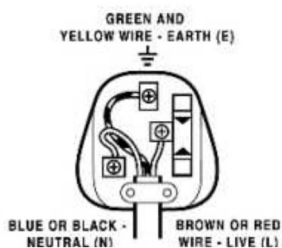

The BLUE wire must be connected to the terminal marked with the letter N

The BROWN wire must be connected to the terminal marked with the letter L

The GREEN & YELLOW wire must be connecting to the terminal marked with the letter E or the earth symbol .

Recycling electrical products



This marking indicates that this product should not be disposed with other household wastes throughout the EU. To prevent possible harm to the environment or human health from uncontrolled waste disposal, recycle it responsibly to promote the sustainable reuse of material resources. To return your used device, please use the return and collection systems or contact the retailer where the product was purchased. They can take this product for environmental safe recycling.

If you encounter any problems with this product please call our customer care team on 0345 640 30 30

Produced in China for Argos Limited, 489 – 499 Avebury Boulevard Central Milton Keynes MK9 2NW. UK.



PRODUCT GUARANTEE

This product is guaranteed against manufacturing defects for a period of



Year

This product is guaranteed for twelve months from the date of original purchase.

Any defect that arises due to faulty materials or workmanship will either be replaced, refunded or repaired free of charge where possible during this period by the dealer from whom you purchased the unit.

The guarantee is subject to the following provisions:

- The guarantee does not cover accidental damage, misuse, cabinet parts, knobs or consumable items.
- The product must be correctly installed and operated in accordance with the instructions contained in this manual. A replacement copy of this instruction manual can be obtained from www.argos-support.co.uk
- It must be used solely for domestic purpose.
- The guarantee will be rendered invalid if the product is re-sold or has been damaged by inexpert repair.
- Specifications are subject to change without notice.
- The manufacturer disclaims any liability for the incidental or consequential damages.
- The guarantee is in addition to, and does not diminish your statutory or legal rights.

Guarantor: Argos Ltd
489 - 499 Avebury Boulevard
Central Milton Keynes
MK9 2NW
www.argos-support.co.uk